

**Standardowe koła do pasów calowych zębatych typu:
XL, L, H, XH**

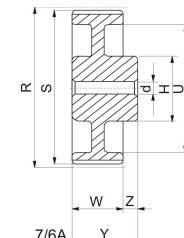
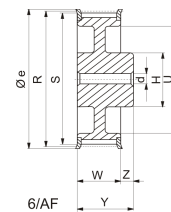
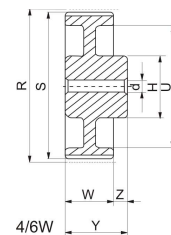
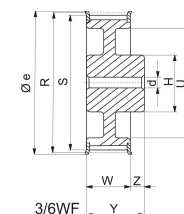
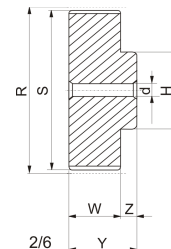
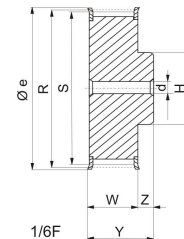

XL 037

kod	typ	typ	liczba zębów	R Ø	S Ø	e Ø	Y	Z	U	H Ø	W	d Ø	(Mx)	Flan-sze	Mater-iał
10 XL 037	1	6F	10	16,17	15,66	20	19,8	5,5	-	9,5	14,3	4	M3	Z FLANSZAMI	STAL
11 XL 037	1	6F	11	17,79	17,28	20	19,8	5,5	-	11,1	14,3	4	M3		
12 XL 037	1	6F	12	19,40	18,89	24	19,8	5,5	-	12,7	14,3	4	M3		
14 XL 037	1	6F	14	22,64	22,13	27	19,8	5,5	-	14,3	14,3	6	M4		
15 XL 037	1	6F	15	24,25	23,74	27	19,8	5,5	-	15,9	14,3	6	M4		
16 XL 037	1	6F	16	25,87	25,36	30	19,8	5,5	-	17,5	14,3	6	M4		
18 XL 037	1	6F	18	29,11	28,60	33	19,8	5,5	-	20,6	14,3	6	M4		
20 XL 037	1	6F	20	32,34	31,83	36	22,2	7,9	-	23,8	14,3	6	M4		
21 XL 037	1	6F	21	33,96	33,45	40	22,2	7,9	-	23,8	14,3	6	M4		
22 XL 037	1	6F	22	35,57	35,06	40	22,2	7,9	-	25,4	14,3	6	M4		
24 XL 037	1	6F	24	38,81	38,30	46	22,2	7,9	-	27,0	14,3	6	M4		
26 XL 037	1	6F	26	42,03	41,53	46	22,2	7,9	-	30,0	14,3	6	M4		
28 XL 037	1	6F	28	45,28	44,77	50	22,2	7,9	-	30,2	14,3	6	M4		
30 XL 037	1	6F	30	48,51	48,00	55	22,2	7,9	-	34,9	14,3	6	M4		
32 XL 037	2	6	32	51,74	51,23	-	25,4	11,1	-	38,0	14,3	6	M4		
36 XL 037	2	6	36	58,21	57,70	-	25,4	11,1	-	38,0	14,3	8	M4		
40 XL 037	2	6	40	64,68	64,17	-	25,4	11,1	-	38,0	14,3	8	M4		
42 XL 037	4	6W	42	67,91	67,40	-	25,4	11,1	-	38,0	14,3	8	M4		
44 XL 037	4	6W	44	71,15	70,64	-	25,4	11,1	-	38,0	14,3	8	M4		
48 XL 037	4	6W	48	77,62	77,11	-	25,4	11,1	-	38,0	14,3	8	M4		
60 XL 037	7	6A	60	97,02	96,51	-	25,4	11,1	-	38,0	14,3	8	M4		
72 XL 037	7	6A	72	116,3	115,92	-	25,4	11,1	-	38,0	14,3	8	M4		

(Mx) Śruby ustalające

L 050

kod	typ	typ	liczba zębów	R Ø	S Ø	e Ø	Y	Z	U	H Ø	W	E	d Ø	Flan-sze	Mater-iał
10 L 050	1	6F	10	30,32	29,56	33,00	26,0	7,0	-	22,0	19,0	-	6	Z FLANSZAMI	STAL
12 L 050	1	6F	12	36,38	35,62	40,00	26,0	7,0	-	28,0	19,0	-	6		
13 L 050	1	6F	13	39,41	38,65	47,00	26,0	7,0	-	30,0	19,0	-	6		
14 L 050	1	6F	14	42,45	41,69	46,00	26,0	7,0	-	33,0	19,0	-	8		
15 L 050	1	6F	15	45,48	44,72	50,00	26,0	7,0	-	36,0	19,0	-	8		
16 L 050	1	6F	16	48,51	47,75	55,00	26,0	7,0	-	38,0	19,0	-	8		
17 L 050	1	6F	17	51,54	50,78	55,00	26,0	7,0	-	40,0	19,0	-	10		
18 L 050	1	6F	18	54,57	53,81	62,00	26,0	7,0	-	40,0	19,0	-	10		
19 L 050	1	6F	19	57,61	56,84	62,00	26,0	7,0	-	40,0	19,0	-	10		
20 L 050	1	6F	20	60,64	59,88	67,00	26,0	7,0	-	46,0	19,0	-	10		
21 L 050	1	6F	21	63,67	62,91	67,00	26,0	7,0	-	48,0	19,0	-	10		
22 L 050	1	6F	22	66,70	65,94	73,00	26,0	7,0	-	50,0	19,0	-	10		
24 L 050	1	6F	24	72,77	72,01	80,00	26,0	7,0	-	50,0	19,0	-	12		
26 L 050	1	6F	26	78,83	78,07	88,00	26,0	7,0	-	50,0	19,0	-	12		
28 L 050	1	6F	28	84,89	84,13	94,00	26,0	7,0	-	50,0	19,0	-	12		
30 L 050	1	6F	30	90,96	90,20	98,00	26,0	7,0	-	50,0	19,0	-	12		
32 L 050	1	6F	32	97,02	96,26	100,00	26,0	7,0	-	50,0	19,0	-	12		
36 L 050	3	6WF	36	109,15	108,39	113,00	26,0	7,0	85,0	50,0	19,0	-	12		
40 L 050	3	6WF	40	121,28	120,52	129,00	26,0	7,0	101,0	50,0	19,0	-	12		
44 L 050	3	6AF	44	133,40	132,64	142,00	26,0	7,0	110,0	50,0	19,0	-	12		
48 L 050	6	6AF	48	145,53	144,77	151,00	26,0	7,0	123,0	50,0	19,0	-	12		
60 L 050	7	6A	60	181,91	181,15	-	28,0	9,0	159,0	50,0	19,0	-	15		
72 L 050	7	6A	72	218,30	217,54	-	28,0	9,0	195,0	50,0	19,0	-	15		
84 L 050	7	6A	84	254,68	253,92	-	28,0	9,0	228,0	50,0	19,0	-	15		

BEZ FLANSZ

